



Hellmuth, Obata & Kassabaum, Inc.
 9530 Jefferson Boulevard
 Culver City, CA 90232 USA
 T: +1 310 838 9555 F: +1 310 838 9586



Charles Pankow Builders, Ltd.
 199 S. Los Robles Avenue, Suite 300
 Pasadena, CA 91101
 T: 626-304-1190

All reproduction & distribution requires written permission of 2023
 in Association with

KPF
 STRUCTURAL AND CIVIL ENGINEERING
 700 Flower St, Suite 2100
 Los Angeles, CA 90017

AEI Affiliated Engineers, Inc.
 MECHANICAL, ELECTRICAL, PLUMBING, TECHNOLOGY
 19 W Colorado Blvd
 Pasadena, CA 91105

Jordan Hughes
 CODE CONSULTANT
 1000 Wilshire Blvd, Suite 250
 Los Angeles, CA 90017

Page & Turnbull
 HISTORIC CONSULTANT
 417 S Hill St, Suite 211
 Los Angeles, CA 90013

Lerch Bates
 ELEVATOR AND FACADE ACCESS CONSULTANT
 2325 E Colorado Blvd, Suite 885
 Pasadena, CA 91107

Colin Gordon & Associates
 VIBRATION
 150 North Hill Drive, Suite 15
 Brisbane, CA 94005

Southwest Fire Protection Co.
 FIRE PROTECTION
 215 E. 5th Street
 Monrovia, CA 91016

Waveguide, LLC
 AUDIOVISUAL
 2400 Tarrant Rd,
 Charlotte, NC 28217

PCI Performance Contracting, Inc.
 FRAMING
 4155 E. La Palma Ave, Ste 100
 Anaheim, CA 92807

Walters & Wolf
 CURTAIN WALL
 1975 Puddingstone Drive
 La Verne, CA 91750

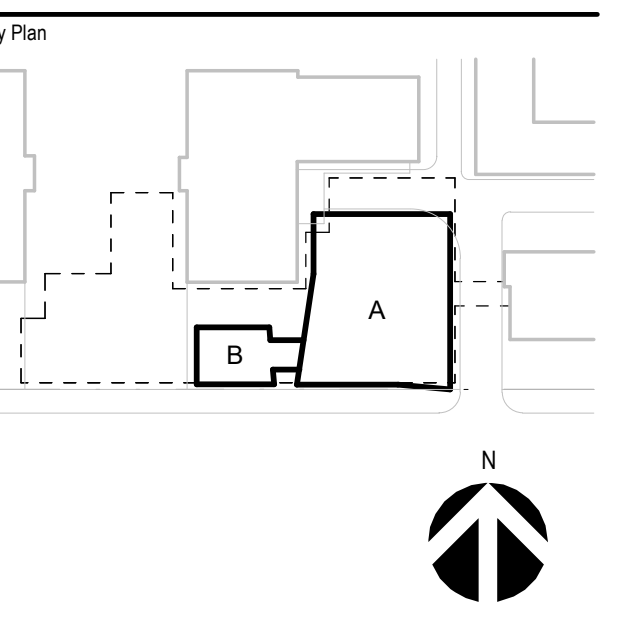

Professional Seal

NOT FOR CONSTRUCTION

NO.	DESCRIPTION	DATE
50%	SCHEMATIC	2023/07/07
100%	DESIGN DEVELOPMENT	2023/11/03

Project No: 21-24141-00
 Sheet Title:

OVERALL SITE PLAN

Original in A1: C&E. Do not scale contents of this drawing.
 Sheet Number

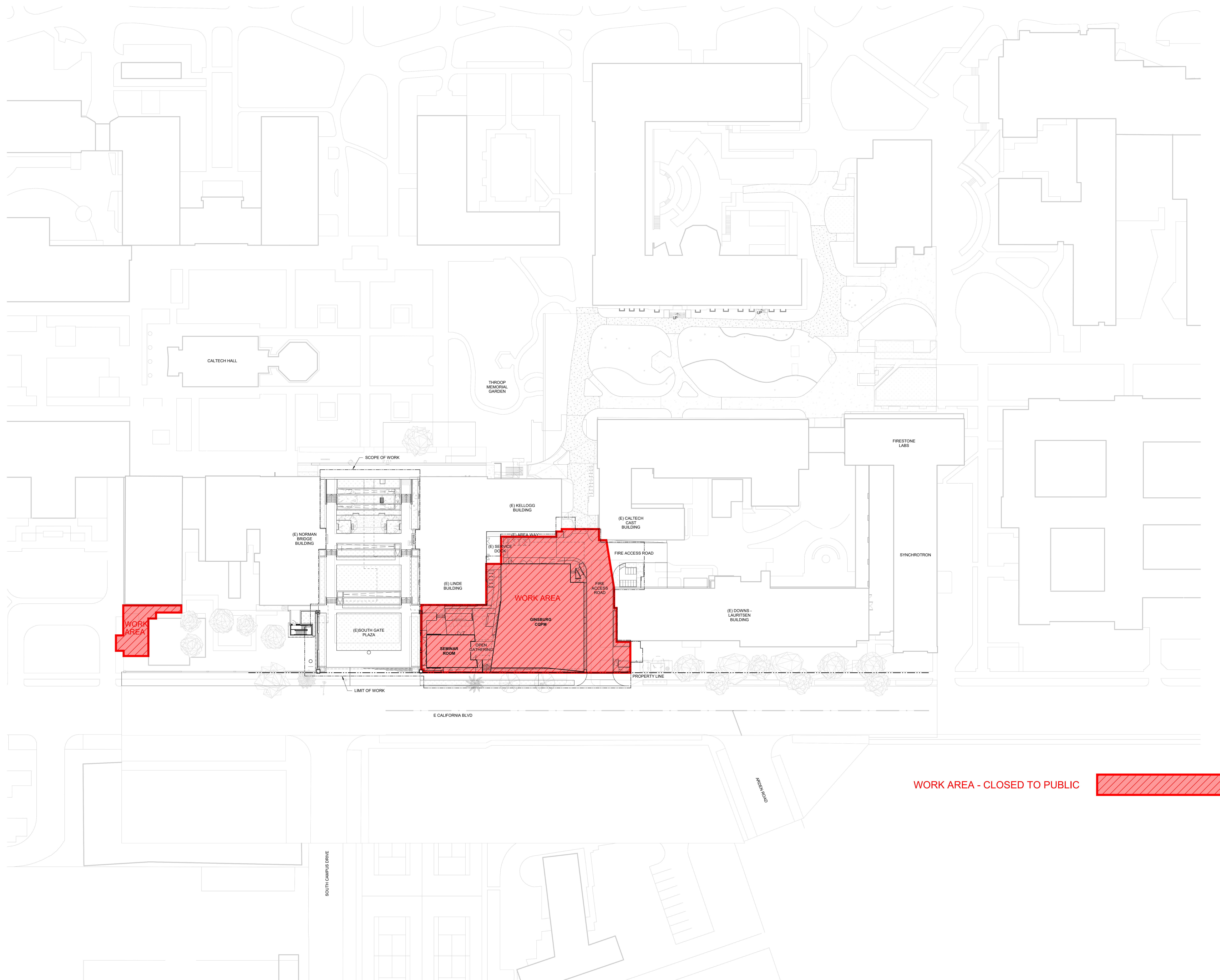

WORK AREA - CLOSED TO PUBLIC

